



**CHANNEL TYPE**

**SELF-ADHESIVE**

ACTUAL SIZE



Color	Model Name	
6000K White	OPC MC53U7512D	69A99
3000K White	OPC MC53U7512WD	69A99
Red	OPC MC53U7512R	69A99
Green	OPC MC53U7512G	69A99
Blue	OPC MC53U7512B	69A99

**DC 12V**

**100 PACK**

80LM ea.

**0.8W**

4W Equivalent



## Description

LED light modules provide consistent illumination for channel letters, sign lighting, under-cabinet lighting, store window lighting, display case lighting, and trade show lighting. Each IP67 waterproof LED module has 3 LEDs and are available in packs of 25 or 100 stranded together upon purchase. LEDs emit a wide 120° beam pattern best suited for illuminating up to 9" wide channel letters that are as shallow as 3". Double-sided 3M adhesive foam tape is included for secure mounting. Narrow PVC modules are injection molded with two screw holes for mounting in extreme cold or heat.

## Mechanical

- IP67 waterproof PVC modules
- Wire pigtail connections
- Rated Life (L70) of 40,000 Hours

## Application

These linear LED modules are well suited for accent lighting, blacklisting, channel letters, displays, home interiors, retrofit lighting, sign lighting, stage & theaters, and under-cabinet lighting.

## Certifications and Compliances



These lights are UL Recognized under UL 879 standards. They are tested and verified as safe to use in a UL-Listed product. Cool white modules are also ISA Approved.

## Photometric

- 120° beam angle
- 57 lm/module (4900K cool white) or
- 22 lm/module (RGB)
- Compatible RGB controller sold separately

## Electrical

[HTTPS://COLLSAM.COM/VDC](https://collsam.com/vdc)

Images May Not Reflect the Actual Product.

Design and specifications are subject to change without notice.

## Dimensions

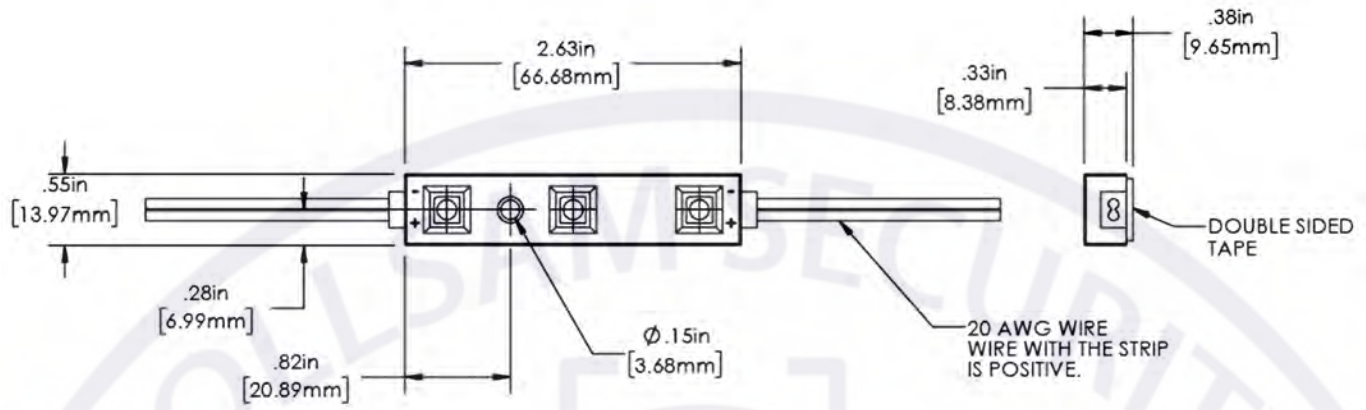

EST.

1998

