

# 4MP Night Color 2.0 Network Bullet Camera

ePoE Fixed-lens Network Camera with Analytics+



## WizMind

WizMind Series devices offer Dahua Analytics+ functions for comprehensive, human-oriented analytic solutions. WizMind Series products are ideal for complex applications with demanding requirements that need advanced analytic capabilities.

### System Overview

The Dahua 4 MP ePoE Night Color 2.0 camera offers Analytics+ functions at the edge – performing complex real-time perimeter protection surveillance, Smart Motion Detection, and face detection. The Dahua Analytics+ algorithms significantly improve accuracy and reliability as compared to standard intelligent features. The camera is ideal for a host of diverse applications — Night Color Technology and Ultra Wide Dynamic Range allow the camera to operate in any lighting condition and the IP67 rating makes the camera suitable for the harshest environments.

### Functions

#### Perimeter Protection

Dahua Analytics+ includes Tripwire and Intrusion functions that offer custom tripwires based on object type for automation in limited access areas. Perimeter Protection requires less pixels to detect an object to deliver improved accuracy and decreased false alarms due to lights, weather, trees, or animals.

#### People Counting

The camera uses complex real-time people counting algorithms to deliver accurate flow statistics from two distinct people counting functions, Line Crossing and Regional. The line crossing function counts the number of people crossing a defined line, and the regional function counts the number of people in a distinct, user-defined area. People counting is ideal for measuring the number of customers entering or exiting a location and to monitor groups of people in a distinct location.

#### Smart Motion Detection+

Smart Motion Detection+, a component of Dahua's Analytics+ technology, improves alarm accuracy and decreases the number of false alarms. The advanced SMD+ algorithm analyzes a scene for human or vehicle motion, while filtering out other motion due to trees, leaves, animals, weather, and triggers an alarm when detected. SMD+ also saves time when searching recorded video by filtering false alarms and allowing quick retrieval of an alarm due to a person or vehicle.

- 1/1.8-in. 4 MP Progressive-scan CMOS Sensor
- Triple-stream Encoding
- AI Coding, Smart H.265+ and Smart H.264+ Video Compression
- 4 MP (2688 x 1520) at 30 fps, 2.8 mm Fixed Lens
- Ultra Wide Dynamic Range (140 dB)
- Built-in Microphone
- Analytics+ Functions — People Counting, Perimeter Protection, Smart Motion Detection+, and Face Detection
- Night Color Technology with White-light LEDs for Color Images in Total Darkness
- Enhanced Power and Data Transmission Distances (ePoE)
- IP67 Ingress Protection
- Five-year Warranty\*



#### Night Color Technology

The Night Color camera incorporates white-light LEDs to offer full-color images in total darkness, as well as an effective visual deterrent. This technology provides smart illumination where the camera automatically activates the white-light illuminators when ambient light levels fall and adjusts exposure time and LED intensity to prevent overexposing the image.

#### ArcticPro

The Dahua ArcticPro Series of extreme-environment cameras combine temperature-tolerant components with a waterproof enclosure to ensure flawless operation in temperatures as low as  $-40^{\circ}\text{C}$  ( $-40^{\circ}\text{F}$ ) without the need for an internal heater. The lack of a heater reduces the camera's power consumption and saves operating costs. For applications that demand high-resolution video with advanced features in extremely cold environments, the Dahua ArcticPro Series offers a camera to satisfy the most demanding requirements.

#### Enhanced Power over Ethernet (ePoE) Technology

Dahua's innovative ePoE technology offers a plug-and-play solution to transmit power and data over long distances via Ethernet or coaxial cables, reducing installation time and saving money. ePoE technology is a viable, cost-effective solution for extending transmission distances and for converting existing, coax-based analog systems into IP systems.

#### Cybersecurity

Dahua network cameras are equipped with a series of key cybersecurity technologies including: security authentication and authorization, access control, trusted protection, encrypted transmission, and encrypted storage. These technologies improve the camera's ability to prevent malicious access and to protect data.

#### Environmental

Subjected to rigorous dust and water immersion tests the camera suitable for the most demanding outdoor applications. The camera carries an IP67 rating that ensures protection from total dust ingress and protection from water immersion between 15 centimeters and 1 meter in depth.

\*Warranty applies to products sold through an authorized Dahua Dealer.

| Technical Specification             |  |   |  |  |  |
|-------------------------------------|--|---|--|--|--|
| Camera                              |  |   |  |  |  |
| Image Sensor                        | 1/1.8-in. 4 MP Progressive-scan CMOS   |   |  |  |  |
| Effective Pixels                    | 2688(H) x 1520(V)  |   |  |  |  |
| RAM/ROM                             | 512 MB/128 MB  |   |  |  |  |
| Scanning System                     | Progressive  |   |  |  |  |
| Electronic Shutter Speed            | Auto, Manual, 1/3 s to 1/100,000 s   |   |  |  |  |
| S/N Ratio                           | > 56 dB  |   |  |  |  |
| Minimum Illumination                | Color: 0.0005 lux at F1.0  |   |  |  |  |
| Illuminator Type                    | White-light LED  |   |  |  |  |
| Illumination Distance               | 40.0 m (131.23 ft)   |   |  |  |  |
| Illuminator Control                 | Automatic, Manual, Off   |   |  |  |  |
| Illuminators                        | Four (4)   |   |  |  |  |
| Lens                                |  |   |  |  |  |
| Lens Type                           | Fixed-focal  |   |  |  |  |
| Mount Type                          | M16  |   |  |  |  |
| Focal Length                        | 2.8 mm   |   |  |  |  |
| Maximum Aperture                    | F1.0   |   |  |  |  |
| Angle of View                       | Horizontal: 107°<br>Vertical: 60°<br>Diagonal: 135°  |   |  |  |  |
| Iris Type                           | Fixed  |   |  |  |  |
| Close Focus Distance                | 1.60 m (5.25 ft)   |   |  |  |  |
| DORI <sup>1</sup> Distance          | Lens<br>2.8 mm   | Detect<br>(8 ppf)<br>58.2 m<br>(190.9 ft)       | Observe<br>(19 ppf)<br>23.3 m<br>(76.4 ft) | Recognize<br>(38 ppf)<br>11.6 m<br>(38.1 ft) | Identify<br>(76 ppf)<br>5.8 m<br>(19.0 ft) |
| Installation Angle                  |  |   |  |  |  |
| Range                               | Pan: 0° to 360°<br>Tilt: 0° to 90°<br>Rotation: 0° to 360°   |   |  |  |  |
| Video                               |  |   |  |  |  |
| Compression                         | AI Coding, Smart H.265+, H.265, Smart H.264+, H.264, H.264B, H.264H, MJPEG (sub stream only)   |   |  |  |  |
| Streaming Capability                | Three (3) Streams  |   |  |  |  |
| Resolution                          | 4 MP (2688 x 1520), 2560 x 1440, 2304 x 1296, 1080p (1920 x 1080), 1.3 MP (1280 x 960), 720p (1280 x 720), D1 (704 x 480), VGA (640 x 480), CIF (352 x 240)  |   |  |  |  |
| Frame Rate                          | Main Stream  | 4 MP (2688 x 1520) at 30 fps                    |  |  |  |
|                                     | Sub Stream 1   | D1 (704 x 480) at 30 fps                        |  |  |  |
|                                     | Sub Stream 2   | 1080p (1920 x 1080) at 1 fps                    |  |  |  |
| Bit Rate Control                    | CBR/VBR  |   |  |  |  |
| Bit Rate                            | H.264: 32 Kbps to 8192 Kbps<br>H.265: 19 Kbps to 8192 Kbps   |   |  |  |  |
| Day/Night                           | Color, B/W   |   |  |  |  |
| BLC Mode                            | BLC, HLC, Ultra WDR (140 dB), SSA  |   |  |  |  |
| White Balance                       | Auto, Natural, Street Lamp, Outdoor, Manual, Regional Custom   |   |  |  |  |
| Gain Control                        | Auto, Manual, Gain Priority, Shutter Priority  |   |  |  |  |
| Noise Reduction                     | 3D DNR   |   |  |  |  |
| Motion Detection                    | Off, On (4 Zones)  |   |  |  |  |
| Region of Interest                  | Off, On (4 Zones)  |   |  |  |  |
| Advanced Features                   | Defog  |   |  |  |  |
| Image Rotation                      | 0°, 90°, 180°, 270°  |   |  |  |  |
| Mirror                              | Off, On  |   |  |  |  |
| Privacy Masking                     | Off, On (8 Areas, Rectangular)   |   |  |  |  |
| Audio                               |  |   |  |  |  |
| Compression                         | G.711A, G.711Mu, G.726, G.723, PCM   |   |  |  |  |
| Network                             |  |   |  |  |  |
| Ethernet                            | RJ-45 (10/100 Base-T)  |   |  |  |  |
| Protocol                            | HTTP, HTTPS, TCP, ARP, RTSP, RTP, UDP, SMTP, FTP, DHCP, DNS, DDNS, PPPOE, IPv4/v6, QoS, UPnP, NTP, ICMP, IGMP, 802.1x  |   |  |  |  |
| Interoperability                    | ONVIF (Profile S/Profile G/Profile T); CGI; Milestone; Genetec; P2P  |   |  |  |  |
| Streaming Method                    | Unicast, Multicast   |   |  |  |  |
| Maximum User Access                 | 20 Users (Total bandwidth: 80 Mbps)  |   |  |  |  |
| Edge Storage                        | Network Attached Storage (NAS)<br>FTP, SFTP<br>Micro SD Card Slot, maximum 256 GB  |   |  |  |  |
| Web Viewer                          | IE (Version 8 and higher), Chrome, Firefox   |   |  |  |  |
| Management Software                 | DSS, DMSS  |   |  |  |  |
| Mobile Operating System             | IOS, Android   |   |  |  |  |
| Cybersecurity                       | Video Encryption, Firmware Encryption, Configuration Encryption, Digest, WSSE, Account Lockout, Security Logs, IP/MAC Filtering, Generating and Importing X.509 Certification, Syslog, HTTPS, 802.1x, Trusted Boot, Trusted Execution, Trusted Upgrade |   |  |  |  |
| Certifications                      |  |   |  |  |  |
| Safety                              | UL60950-1, CAN/CSA C22.2 No.60950-1-07 EN62368-1   |   |  |  |  |
| Electromagnetic Compatibility (EMC) | CFR 47 FCC Part 15 Subpart B<br>Electromagnetic Compatibility Directive 2014/30/EU   |   |  |  |  |
| Interface                           |  |   |  |  |  |
| Audio                               | Input  | One (1) Channel, RCA plus a built-in Microphone |  |  |  |
|                                     | Output   | One (1) Channel, RCA                            |  |  |  |
| Alarm                               | Input  | One (1) Channel, 5mA, 3V to 5V DC               |  |  |  |
|                                     | Output   | One (1) Channel, 300mA, 12V DC                  |  |  |  |
| Electrical                          |  |   |  |  |  |
| Power Supply                        | 12 VDC ±30%, PoE (IEEE 802.3af, Class 0), or ePoE  |   |  |  |  |
| Power Consumption                   | Basic  | 12 VDC: 2.2 W<br>PoE: 2.8 W                     |  |  |  |
|                                     | Maximum  | 12 VDC: 7.4 W<br>PoE: 8.4 W                     |  |  |  |
| Environmental                       |  |   |  |  |  |
| Operating Conditions                | -40° C to +60° C (-40° F to +140° F),<br>Less than 95% RH  |   |  |  |  |
| Storage Conditions                  | -40° C to +60° C (-40° F to +140° F),  |   |  |  |  |
| Ingress Protection                  | IP67   |   |  |  |  |

Construction

|                        |  |
|------------------------|--|
| Casing                 | Metal  |
| Dimensions (L x W x H) | 244.10 mm x 79.0 mm x 75.90 mm<br>(9.61 in. x 3.11 in. x 2.99 in.) |
| Net Weight             | 0.82 kg (1.80 lb)  |
| Gross Weight           | 1.08 kg (2.38 lb)  |

Analytics+ Functions<sup>2</sup>

|                                |   |                         |
|--------------------------------|---|-------------------------|
| Smart Plan Schedule            | Enable Analytics+ functions depending on a user-defined schedule. Allows the camera to switch analytic functions based on time.   |                         |
| Perimeter Protection           | <ul style="list-style-type: none"> <li>Detects human or vehicle violations using the following methods:                             <ul style="list-style-type: none"> <li><b>Tripwire:</b> a target crosses a defined line.</li> <li><b>Intrusion:</b> a target enters or exits a defined perimeter.</li> </ul> </li> <li>Monitors a combination of detection methods.</li> <li>Search and retrieve video based on target type.</li> </ul>                     |                         |
| People Counting                | <ul style="list-style-type: none"> <li>Delivers accurate flow statistics from the following methods:                             <ul style="list-style-type: none"> <li><b>Line Crossing:</b> counts a person as they cross a threshold in a defined direction.</li> <li><b>Region:</b> counts the number of people in a defined area.</li> </ul> </li> <li>Counts people simultaneously from four (4) threshold lines and four (4) defined regions.</li> </ul> |                         |
| Queue Management               | <ul style="list-style-type: none"> <li>Monitors four (4) user-defined regions where people wait in line (or queue). Issues an alarm for the following triggers:                             <ul style="list-style-type: none"> <li><b>People in Line:</b> the number of people in line exceeds a minimum threshold.</li> <li><b>Wait Time:</b> time a person waits in line is greater than the minimum queue time.</li> </ul> </li> </ul>                       |                         |
| Face Detection                 | <ul style="list-style-type: none"> <li>Detects and captures a snapshot of a human face within a scene.</li> </ul>   |                         |
| Smart Motion Detection+        | <ul style="list-style-type: none"> <li>Differentiates between and classifies human and vehicle objects.</li> <li>Filters false alarms due to leaves, lights, animals, and other inconsequential objects.</li> <li>Extracts human or vehicle objects from recorded video for quick target search and retrieval.</li> </ul>   |                         |
| Recommended Detection Distance | Human   | Up to 10.0 m (32.81 ft) |
|                                | Vehicle   | Up to 15.0 m (49.21 ft) |

Intelligent Video System Functions

IVS triggers an alarm and takes a defined action for the following events:

|                     |  |
|---------------------|--|
| Standard Features   | <ul style="list-style-type: none"> <li>Tampering with the camera.</li> <li>Error writing to an onboard Micro SD card.</li> <li>Error sending or receiving data over the network.</li> <li>Unauthorized access to the camera.</li> <li>IP Address Conflict</li> </ul> |
| Premium Features    |  |
| Missing Object      | An object is missing from a designated area.   |
| Abandoned Object    | An object is placed in a designated area where no object should be.  |
| Scene Change        | A person or object moves the camera to change the scene or covers the camera to obscure the scene.   |
| Fast Moving         | Target exceeds a set speed when exiting a defined area   |
| Parking Detection   | Vehicle remains in a defined area without motion for a set period of time.   |
| Crowd Gathering     | Specified number of people remain inside a defined area for a set time.  |
| Loitering Detection | Target is in motion inside a defined area longer than a specified amount of time.  |

ePoE Transmission Distances

Via CAT5E/CAT6 Ethernet Cable

ePoE supply voltage 48 V  
Maximum DC resistance < 10 Ω/100 m

| Cable Length, m (ft) | Bandwidth, Mbps | PoE Load Capacity, W | Hi-PoE Load Capacity, W | Working Mode |
|----------------------|-----------------|----------------------|-------------------------|--------------|
| 100 (328)            | 100             | 25.5                 | 53                      | IEEE/E100    |
| 200 (656)            | 100             | 25.5                 | 33                      | E100         |
| 300 (984)            | 100             | 19                   | 19                      | E100         |
| 400 (1312)           | 10              | 17                   | 17                      | E10          |
| 500 (1640)           | 10              | 13                   | 13                      | E10          |
| 800 (2625)           | 10              | 7                    | 7                       | E10          |

Via CAT5E/CAT6 Ethernet Cable

ePoE supply voltage 53 V  
Maximum DC resistance < 10 Ω/100 m

| Cable Length, m (ft) | Bandwidth, Mbps | PoE Load Capacity, W | Hi-PoE Load Capacity, W | Working Mode |
|----------------------|-----------------|----------------------|-------------------------|--------------|
| 100 (328)            | 100             | 25.5                 | 53                      | IEEE/E100    |
| 200 (656)            | 100             | 25.5                 | 47                      | E100         |
| 300 (984)            | 100             | 25.5                 | 32                      | E100         |
| 400 (1312)           | 10              | 23                   | 26                      | E10          |
| 500 (1640)           | 10              | 20                   | 20                      | E10          |
| 800 (2625)           | 10              | 13                   | 13                      | E10          |

Via RG-59 Coaxial Cable

ePoE supply voltage 48 V  
Maximum DC resistance < 5 Ω/100 m

| Cable Length, m (ft) | Bandwidth, Mbps | PoE Load Capacity, W | Hi-PoE Load Capacity, W | Working Mode |
|----------------------|-----------------|----------------------|-------------------------|--------------|
| 100 (328)            | 100             | 25.5                 | 50                      | IEEE/E100    |
| 200 (656)            | 100             | 25.5                 | 30                      | E100         |
| 300 (984)            | 100             | 18                   | 18                      | E100         |
| 400 (1312)           | 100             | 15                   | 15                      | E100         |
| 500 (1640)           | 10              | 12                   | 12                      | E10          |
| 800 (2625)           | 10              | 6                    | 6                       | E10          |
| 1000 (3281)          | 10              | 5                    | 5                       | E10          |

Via RG-59 Coaxial Cable

ePoE supply voltage 53 V  
Maximum DC resistance < 5 Ω/100 m

| Cable Length, m (ft) | Bandwidth, Mbps | PoE Load Capacity, W | Hi-PoE Load Capacity, W | Working Mode |
|----------------------|-----------------|----------------------|-------------------------|--------------|
| 100 (328)            | 100             | 25.5                 | 52                      | IEEE/E100    |
| 200 (656)            | 100             | 25.5                 | 48                      | E100         |
| 300 (984)            | 100             | 25.5                 | 30                      | E100         |
| 400 (1312)           | 100             | 20                   | 23                      | E100         |
| 500 (1640)           | 10              | 16                   | 16                      | E10          |
| 800 (2625)           | 10              | 10                   | 10                      | E10          |
| 1000 (3281)          | 10              | 8                    | 8                       | E10          |

1. The DORI distance is a measure of the general proximity for a specific classification to help pinpoint the right camera for your needs. The DORI distance is calculated based on sensor specifications and lab test results according to EN 62676-4, the standard that defines the criteria for the Detect, Observe, Recognize and Identify classifications.

2. Pair a Smart Motion Detection camera with a Dahua recording device that also offers SMD functionality to take advantage of SMD alarm filtering and object classification when searching and playing back recorded video.

**Ordering Information**

| Type                       | Part Number   | Description  |
|----------------------------|---------------|--|
| Analytics+ Camera          | N45EFN2       | 4 MP ePoE Night Color 2.0 Fixed Lens Bullet Camera with Analytics+ |
| Accessories, optional      | PFA130-E      | Junction Box   |
|                            | PFA151        | Corner Mount   |
|                            | PFA152-E      | Pole Mount   |
|                            | DH-PFM321D-US | 12 VDC, 1 A Power Adapter  |
| ePoE Accessories, optional | LR1002        | EoC Passive Converter  |
|                            | LR1002-1EC    | Single-port EoC Receiver   |

**Accessories**

Optional:



PFA130-E  
Junction Box



PFA151  
Corner Mount



PFA152-E  
Pole Mount



DH-PFM321D-US  
12 VDC, 1 A  
Power Adapter



LR1002  
EoC Passive  
Converter



LR1002-1EC  
Single-port EoC  
Receiver

**Mounting Diagram**

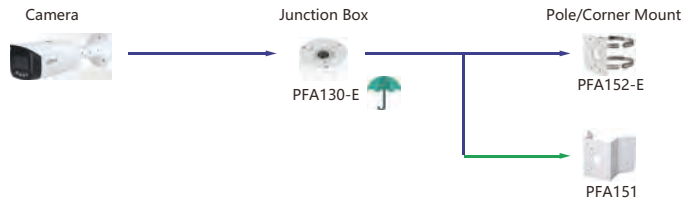

**Dimensions**

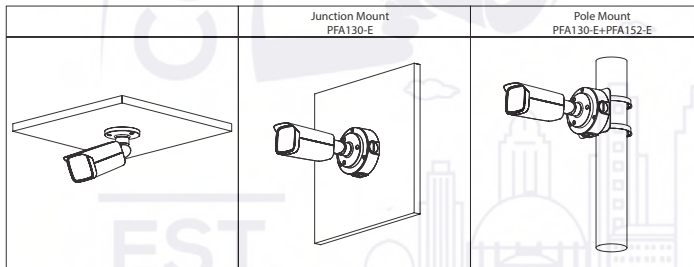
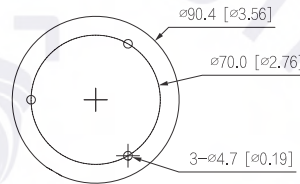
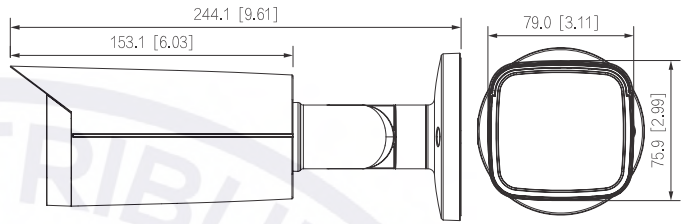

1998

WE SECURE YOUR LIFE

